

Nuts Finished Hex LHT

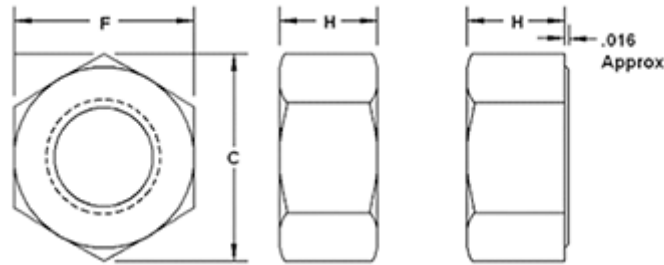

Finished Pattern Nuts

SAE J995 Grade 2, ASTM A563

Plain = NFL020----

Zinc = NFL020----Z1

Nominal Size	F	C		H	Weight Per C
	Width Across Flats	Width Across Corners		Thickness Hex Nut	
		Max	Min		
1/4	7/16	0.505	0.488	7/32	.68
5/16	1/2	0.577	0.557	17/64	1.02
3/8	9/16	0.650	0.628	21/64	1.49
7/16	11/16	0.794	0.768	3/8	2.75
1/2	3/4	0.866	0.840	7/16	3.60
9/16	7/8	1.010	0.982	31/64	5.67
5/8	15/16	1.083	1.083	35/64	7.11
3/4	1-1/8	1.299	1.240	41/64	11.80
7/8	1-5/16	1.516	1.447	3/4	17.67
1	1-1/2	1.732	1.653	55/64	26.60
1-1/8	1-11/16	1.949	1.859	31/32	39.80
1-1/4	1-7/8	2.165	2.066	1-1/16	51.70
1-3/8	2-1/16	2.382	2.273	1-11/64	73.00
1-1/2	2-1/4	2.598	2.480	1-9/32	88.10
1-5/8	2 7/16			1-25/64	117
1-3/4	2-5/8			1-1/2	151
1 7/8	2-3/4			1-3/4	204
2	3			1-23/32	224
2 1/4	3-3/8			1-59/64	317
2 1/2	3-3/4			2-9/64	435

$2\frac{3}{4}$	$4\frac{1}{8}$			$2\frac{23}{64}$	573
3	$4\frac{1}{2}$			$2\frac{37}{64}$	740